

Deck plans

Viking Kirov / Viking Surkov

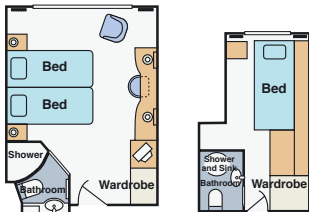

Deluxe Stateroom
(Cat A, B, C, F)
161 sq. ft.
15 m²

Single Stateroom
(Cat CS)
79 sq. ft.
7.3 m²

Windows open in all stateroom categories except Cat E and F which have portholes.

Built 1984–1990, completely renovated 2008/09, 5 decks, 210 guests, 114 crew

106 staterooms. All cabins are outside, with A/C, private bathroom and shower, flat screen TV, phone, fridge, safe, hairdryer. Deluxe categories and suites have hotel-style beds. Windows open in the suites and categories A, B, C, D Deluxe and singles. Onboard facilities: 3 walk-around open-air promenade decks, restaurant with panoramic views, elevator, observation lounge and 2 bars, Sun Deck, library, internet café, souvenir shop, doctor, laundry service.

■ Suite ■ Cat A Deluxe □ Cat B Deluxe ■ Cat C Deluxe ■ Cat D Deluxe ■ Cat E Deluxe □ Cat F Deluxe ■ Cat CS (Single)

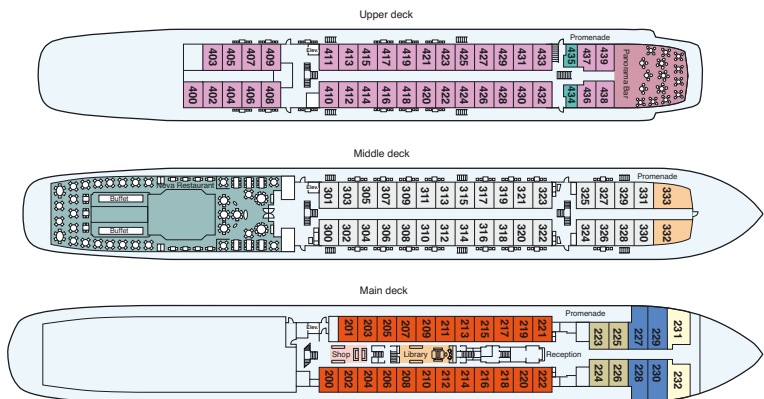
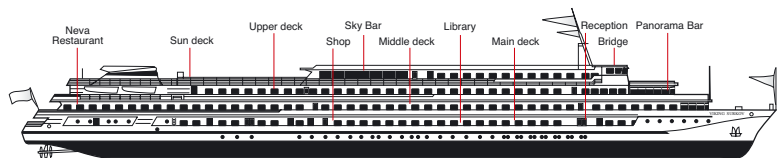

Windows open in all stateroom categories except Cat E and Cat F.

Viking Pakhomov

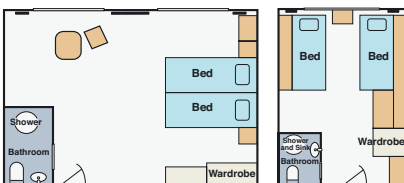

Deluxe Cabin
(Cat. AX, BX) 18.95m²
Hotel-style beds

Standard Cabin
(Cat. C, D, E, F) 8.36m²

Single cabin
(Cat. CS) 6.97m²

Please note Categories C, D, E, F & CS have yacht-style bathrooms with hand-held shower.

Built 1984–1990, refurbished 2003, 5 decks, 212 guests, 114 crew

110 staterooms. All staterooms are outside, with A/C, private bathroom & shower, fridge. Windows open in all categories. Deluxe categories & suites have hotel-style beds. Onboard facilities: 3 walk-around open-air promenade decks, 2 restaurants, observation lounge, 2 bars, internet café, library, Sun Deck, souvenir shop, sauna, laundry service, doctor and hairdresser. Safe at reception.

■ Suite ■ Cat A Deluxe □ Cat B Deluxe □ Cat C ■ Cat D ■ Cat E □ Cat F ■ Cat CS (Single)

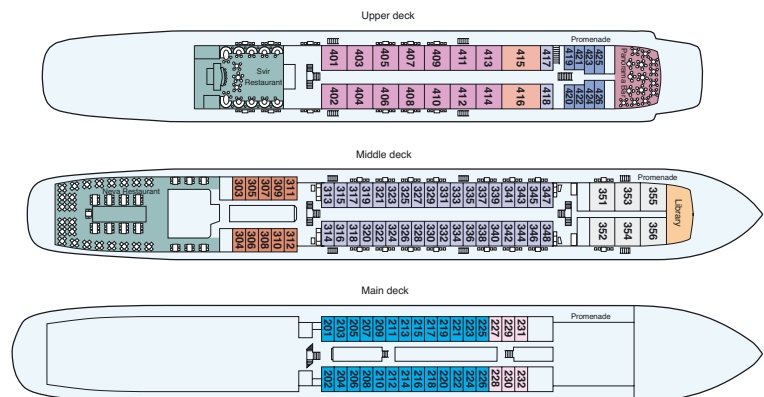
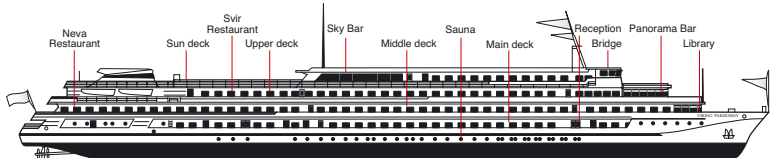

Windows open in all stateroom categories.