

# Ships, deck plans & staterooms

Viking Pakhomov, Viking Lavrinenkov



Viking Pakhomov

Cruise aboard western-owned and managed ships in Russia.

Built 1984–1990, refurbished 2003, 5 decks, 212 guests, 114 crew

110 staterooms. All staterooms are outside, with A/C, private bathroom & shower, TV, fridge (Lavrinenkov only) Windows open in all categories. Deluxe categories & suites have hotel-style beds. On board facilities: 3 walk-around open-air promenade decks, 2 restaurants, observation lounge, 2 bars, internet café, library, Sun Deck, souvenir shop, sauna, laundry service, doctor and hairdresser. Safe at reception.



Bar



Cat. A and B



Cat. C, D, E and F

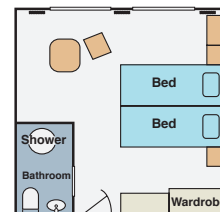
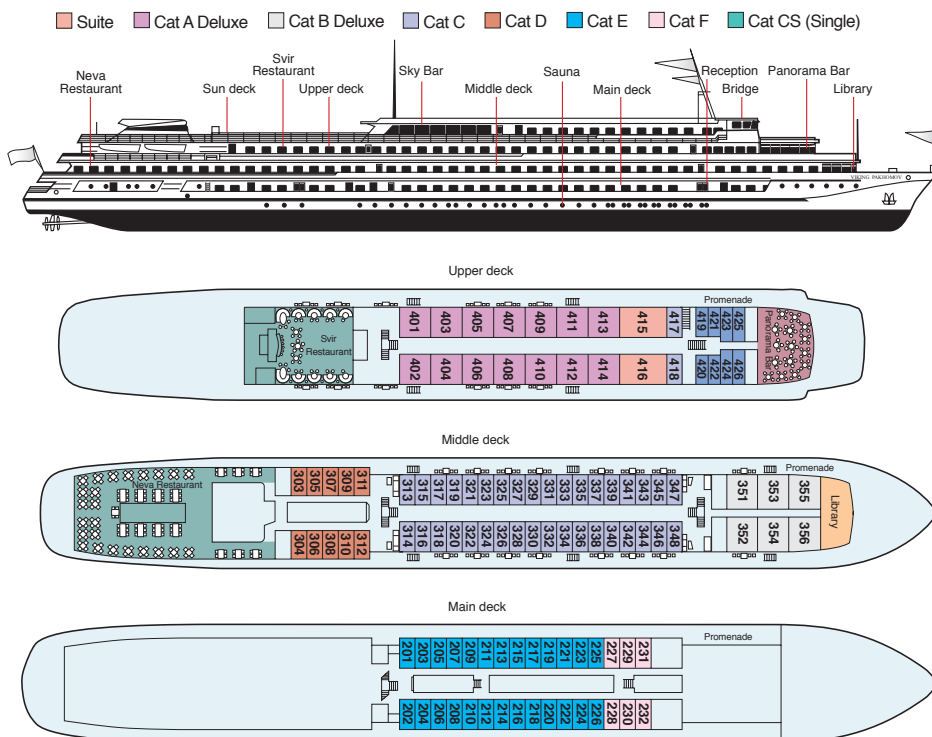

Deluxe Stateroom  
(Categories A & B Deluxe)  
204 sq. ft.  
19 m<sup>2</sup>

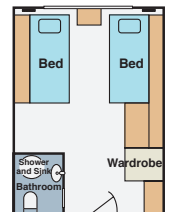

Standard Stateroom  
(Cat C, D, E, F)  
90 sq. ft.  
8.5 m<sup>2</sup>

Single Stateroom  
(Cat CS)  
75 sq. ft. / 6.9 m<sup>2</sup>

Please note: Categories C, D, E, F and CS have yacht-style bathrooms with hand-held shower head.

Windows open in all stateroom categories.